

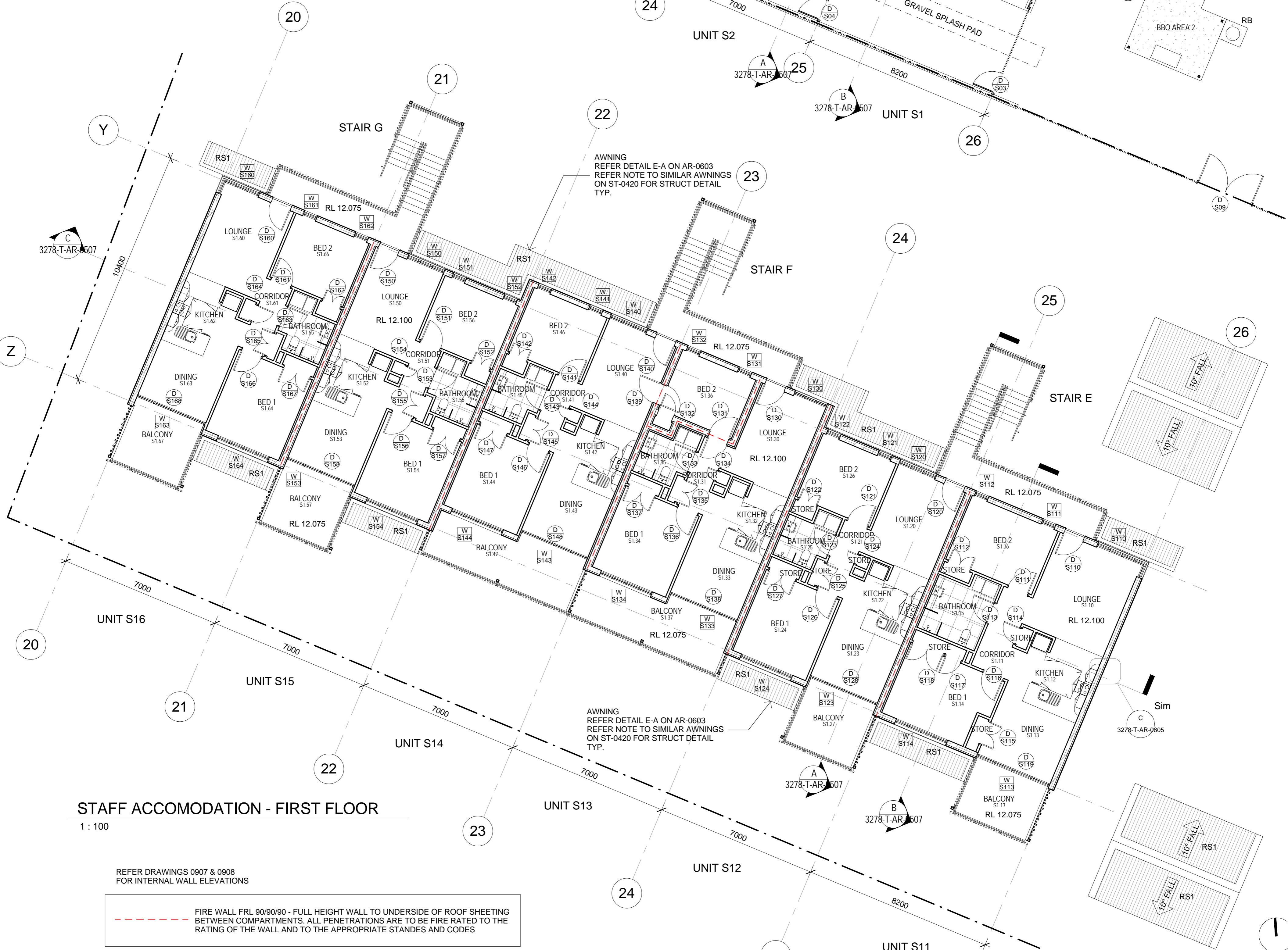

**STAFF ACCOMODATION - GROUND FLOOR**  
1 : 100



**STAFF ACCOMODATION - FIRST FLOOR**  
1 : 100

REFER DRAWINGS 0907 & 0908 FOR INTERNAL WALL ELEVATIONS

--- FIRE WALL RL 90/90/90 - FULL HEIGHT WALL TO UNDERSIDE OF ROOF SHEETING BETWEEN COMPARTMENTS. ALL PENETRATIONS ARE TO BE FIRE RATED TO THE RATING OF THE WALL AND TO THE APPROPRIATE STANDARDS AND CODES

AWNING REFER DETAIL E-A ON AR-0603 REFER NOTE TO SIMILAR AWNINGS ON ST-0420 FOR STRUCT DETAIL TYP.

AWNING REFER DETAIL E-A ON AR-0603 REFER NOTE TO SIMILAR AWNINGS ON ST-0420 FOR STRUCT DETAIL TYP.

**TENDER ISSUE - NOT FOR CONSTRUCTION**

FISHER BUTTROSE ARCHITECTS PTY LTD  
ABN 078 745 856  
P O BOX 11707 F 07 4041 5881  
LEVEL 1, 116 GRAFTON STREET  
4807 PO BOX 5107  
CAIRNS QUEENSLAND AUSTRALIA  
www.fisherbttrose.com.au

**AMENDMENTS**

ISSUE	DATE	DESCRIPTION	INT
1	16-02-2011	TENDER ISSUE	BK



**WESTERN CAPE RESIDENTIAL CAMPUS**  
TAMARIND ROAD, WEIPA  
INDIGENOUS LAND CORPORATION

**STAFF ACCOMMODATION - FLOOR PLANS**  
SCALE AT A1 1 : 100

APPROVED MB DRAWN BK PROJECT No. 1008  
DRAWING No. 3278-T-AR-0250 ISSUE 1

23/02/2011 10:28:52 AM