

STAFF ACCOMODATION - GROUND FLOOR STRUCTURAL SETOUT

1 : 100

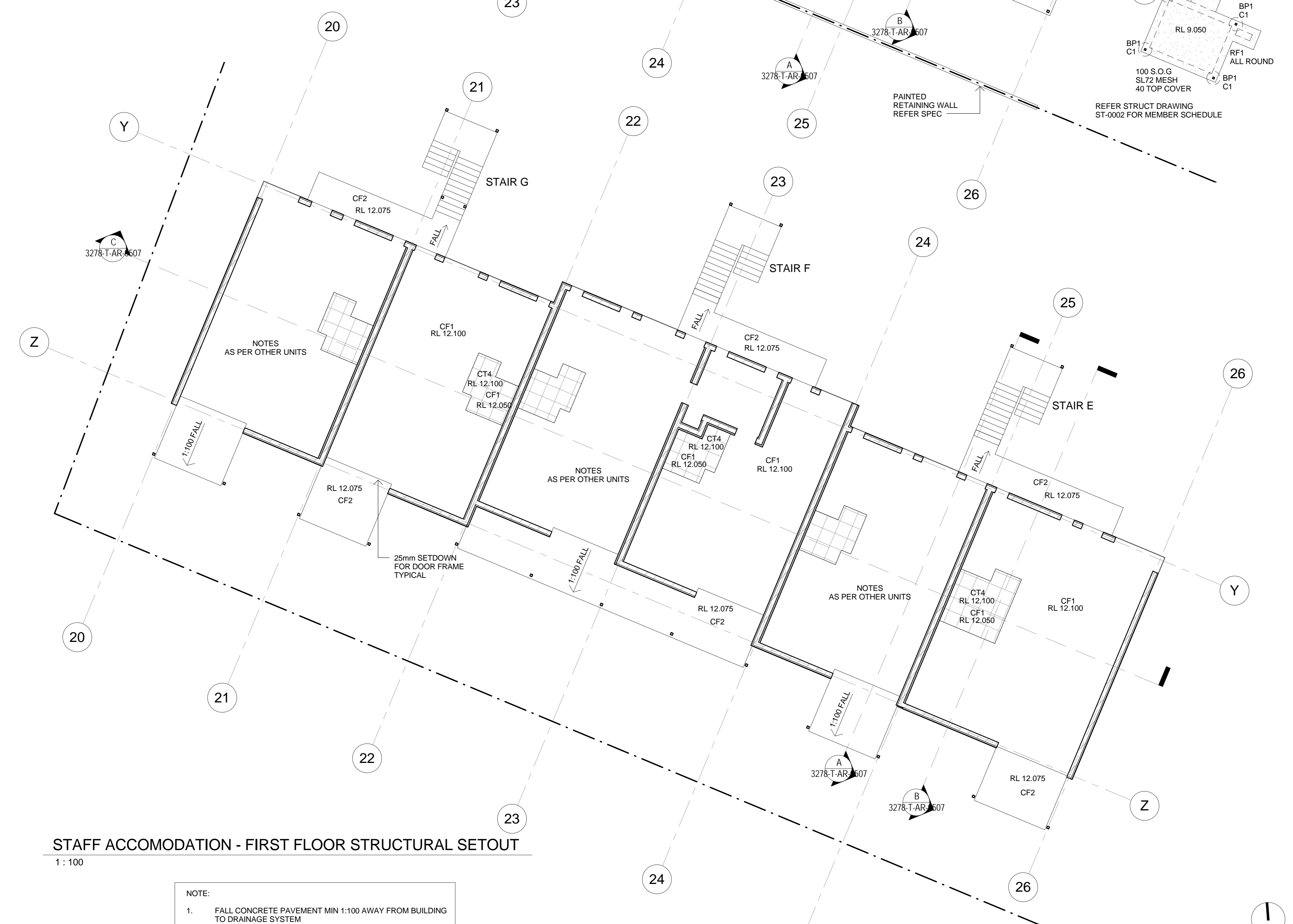

STAFF ACCOMODATION - FIRST FLOOR STRUCTURAL SETOUT

1 : 100

NOTE:

1. FALL CONCRETE PAVEMENT MIN 1:100 AWAY FROM BUILDING TO DRAINAGE SYSTEM
2. PROVIDE FALLS TO FLOOR WASTES AT REQUIRED GRADES

TENDER ISSUE - NOT FOR CONSTRUCTION

FISHER BUTTROSE ARCHITECTS PTY LTD
 ABN 078 745 856
 P 07 4031 1707 F 07 4041 5881
 LEVEL 1, 116 GRAFTON STREET
 4807 PO BOX 5107
 CAIRNS QUEENSLAND AUSTRALIA
 www.fisherbttrosc.com.au

AMENDMENTS

ISSUE	DATE	DESCRIPTION	INT
1	16-02-2011	TENDER ISSUE	BK



WESTERN CAPE
 RESIDENTIAL CAMPUS
 TAMARIND ROAD, WEIPA
 INDIGENOUS LAND CORPORATION

STAFF ACCOMMODATION
 - SETOUT PLANS

SCALE AT A1 1 : 100

APPROVED MB DRAWN BK PROJECT No. 1008

DRAWING No. 3278-T-AR-0252 ISSUE 1

23/02/2011 10:30:05 AM